

# Hôpital d'Estaing, Clermont-Ferrand

**Client**

Centre Hospitalier Universitaire de  
Clermont-Ferrand

**Program**

Construction of the new Hôpital  
d'Estaing in Clermont-Ferrand

**Selection method**

Public competition

**Team**

Groupe-6 (Architect, Lead consultant) -  
Jacobs France (Engineering)

**Competition**

2007

**Completion**

2010

**Surface area**

70,000 m<sup>2</sup>

**Capacity**

565 lits et places

**Construction costs**

162 M€

**Location**

Clermont-Ferrand

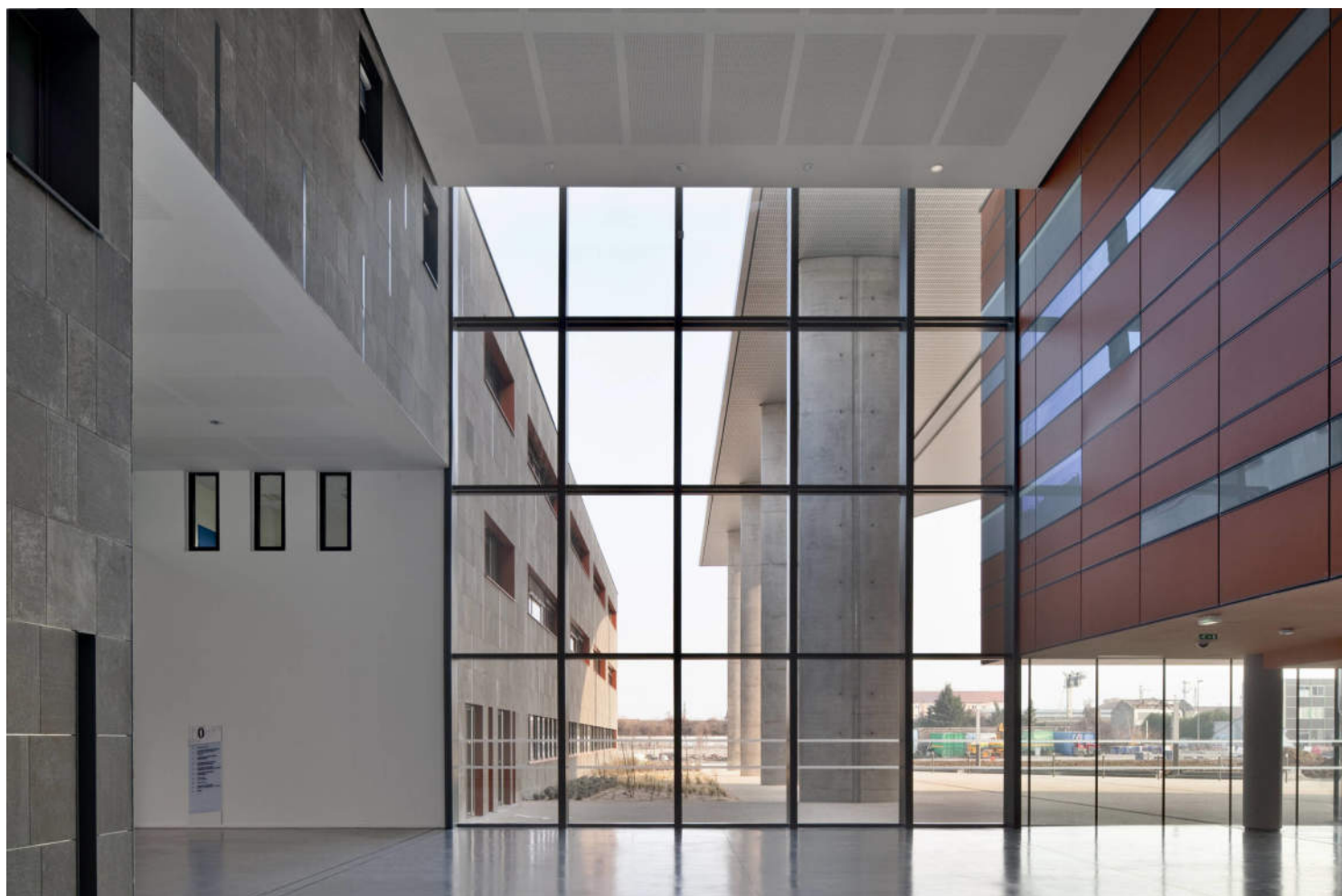

# Hôpital d'Estaing, Clermont-Ferrand

Located in the new Estaing district on the site of former Michelin factories, the new hospital project was intended to make it a real hub within the city, a basis for the development of the new district. The monumental treatment of the entrance courtyard clearly marks the hospital's presence in the life of the city and expresses the institution's social dimension. Our intention was to provide

a 'human-sized' answer to a programme with complex functionalities. We voluntarily took the horizontal and fragmented approach to bring a more intimate dimension to the site and provide simple, direct links between the different departments. The organisational structure can be used to provide great potential for development of the premises as a whole.

